



Iron-on Timber Veneer Sheet

- Shelving
- Cabinets & cupboard doors
- Stereo speaker boxes
- Renovation of old furniture

Instructions

The Iron-On Timber Veneer Sheet is designed and recommended for application directly onto wooden substrates such as particleboard, MDF (fibreboard) and plywood.

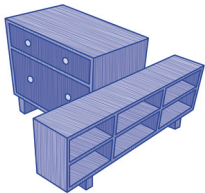

Suggested Applications

- Shelving
- Cabinets & cupboard doors
- Stereo speaker boxes
- Renovation of old furniture
- Hobby crafts

How it works - The Iron-On Timber Veneer Sheet is coated on the back with a special hot melt adhesive. With heat from an ordinary domestic iron, the adhesive is melted to form a bond with the surface of the substrate.

Note - The Iron-On Timber Veneer Sheet is not recommended for application onto metal, glass, or other sealed surfaces.

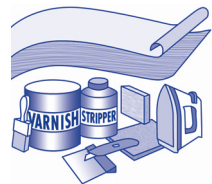

What else will you need?

A stiff-bristled brush; Brown or grease proof paper (not vital); A hard roller or flat wooden block (palm-sized); A router, fine file, chisel, or utility knife; Fine sandpaper; Timber stain/lacquer.

If applying an Iron-On Timber Veneer Sheet to laminate or painted surface: Coarse sandpaper and/or paint stripper.

Preparation -

1. SUBSTRATE SURFACE: Remove laminate or paint using coarse sandpaper and/or paint stripper. Clean-up substrate surface using stiff-bristled brush.

2. IRON-ON TIMBER VENEER SHEET: Measure and cut the sheet allowing 5mm overlap on each end.

3. DOMESTIC IRON: Turn off steam function. Set iron to high heat (cotton setting).

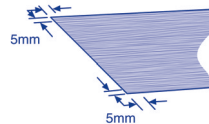

Method -

1. POSITION THE SHEET: Lay sheet over substrate allowing equal overlap on all sides for trimming.

2. COVER THE SHEET (not vital): Cover the sheet with brown or grease proof paper to protect lacquered surface of the sheet from excessive direct heat from iron.

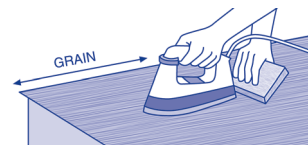

3. IRON-ON: Use one hand to guide and keep the sheet in position. Starting at one end, iron back and forth. Slowly continue forwards.

4. FOLLOW-UP PRESSURE: Rub wooden block or push roller back and forth immediately after ironing (whilst sheet and adhesive still warm) to keep sheet in contact with substrate surface as adhesive cools.

Note - If result is not acceptable, re-work by repeating steps 3 and 4.

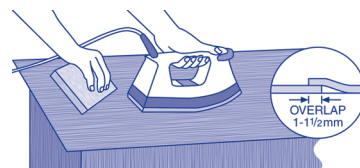

5. JOINING: When joining two pieces of Iron-On Timber Veneer Sheet on a wide surface, position the first piece and iron down, starting along the joint edge first. Next, lay the second sheet alongside,

overlapping approximately 1-1.5mm onto the fixed piece, to allow for slight shrinkage of veneer due to moisture loss. To prevent veneer moving, apply the iron to a small spot at each end of the overlapping joint. Now iron hard alongside the joint but do not iron on the overlap itself. Rub down well with the follow-up block held at an angle. This will assist the overlap to drop down alongside the fixed leaf and form a perfect joint. Once the joint is completed, continue to iron remaining section of leaf down, working along the grain at all times.

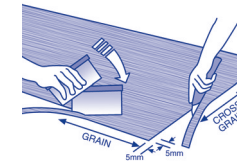

6. TRIMMING: Ideally use a router. Alternatively: With fine file – Move file at close angle (15°) to surface of board. With chisel or utility knife – Work along surface of substrate. Trim carefully to avoid damaging surface of substrate. In all cases, work away from the sheet towards surface of substrate to stop the sheet pulling away.



7. FINISHING: If required, fine sandpaper trimmed edges to smooth finish. If desired, the Iron-on Timber Veneer Sheet can be stained. Apply any standard timber finish.

For more information and application hints see our website

www.cvedging.com.au

Please note - The above instructions and information are given in good faith and are based on our testing and experience. All recommendations and suggestions are made without a guarantee of any kind as strict adherence to application instructions, substrate quality and working conditions are beyond our control.

Made in Australia by Consolidated Veneers